

AYVAZ BRONZE CHECK VALVE



Design:

- Renewable Seat Disc
- Screwed Cap
- Resistant to dezincification
- Seat relocating while the valve is in the line
- Threaded Ends

Features:

Suitable for hot or cold water and steam applications
 Suitable for Oily media
 PN 20 Pressure Rating
 Max. working temperature: 170°C
 Taper Pipe Thread EN ISO 7/1

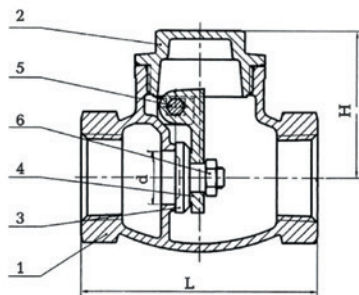

MATERIAL LIST

Part Number	Part Name	Material
1	Body	Bronze CC491K
2	Cap	Bronze CC491K
3	Disc	Bronze CC491K
4	Hinge	Brass CW617N
5	Hinge Pin	Stainless Steel 2Cr13
6	Hinge Nut	Brass CW617N

DIMENSIONS

DN	d	L	H
15	13	58	37
20	19	66	43
25	25	76	49
32	32	88	57,5
40	39	96	63
50	50	112	72