

YS-800

Y-TIP DİŞLİ PİSLİK TUTUCU

Y-TYPE SCREWED END STRAINERS

- * Hassas döküm
- * Y - tipi
- * Paslanmaz çelik süzgeç
- * Dişli iç kap
- * Bağlantı vida dişleri:
ANSI B2.1 / BS 21 / DIN
- * Çalışma basıncı: 60 bar
- * Çaplar: 1/2"- 2"
- * Investment casting
- * Y type
- * SS 316 screen
- * Screwed - in cap
- * Connecting threads:
ANSI B2.1 / BS 21 / DIN
- * Working pressure: 800 psi
- * Sizes: 1/2"- 2"



YEDEK PARÇALAR / SPARE PARTS

| NO | Parça adı / Part name | Malzeme / Material |
|----|---------------------------|--------------------|
| 1 | Gövde / Body | ASTM A351 - CF8M |
| 2 | Süzgeç / Screen | SS 316 |
| 3 | Conta / Gasket | Teflon |
| 4 | Kaporta / Bonnet | ASTM A351 - CF8M |
| 5 | O - ring | Viton |
| 6 | Tahliye tapası / Blow off | ASTM A351 - CF8M |

BOYUTLAR / DIMENSIONS

| Ölçü / Size (mm) | 1/4" | 3/8" | 1/2" | 3/4" | 1" | 1- 1/4" | 1- 1/2" | 2" |
|------------------|----------------|----------------|----------------|----------------|--------------|-------------------|-------------------|--------------|
| A | 10 | 12 | 15 | 20 | 25 | 32 | 40 | 50 |
| B | 22 | 22 | 26 | 32 | 40 | 48 | 55 | 68 |
| (H) | 43 | 43 | 45 | 52 | 68 | 70 | 80 | 98 |
| L | 64 | 64 | 64 | 80 | 90 | 106 | 119 | 140 |
| F | 1/4 BSP or NPT | 3/8 BSP or NPT | 1/2 BSP or NPT | 3/4 BSP or NPT | 1 BSP or NPT | 1- 1/4 BSP or NPT | 1- 1/2 BSP or NPT | 2 BSP or NPT |
| W | 2 | 2 | 2 | 2 | 2 | 2 | 2 | 2 |
| d | 1 | 1 | 1 | 1 | 1 | 1 | 1 | 1 |

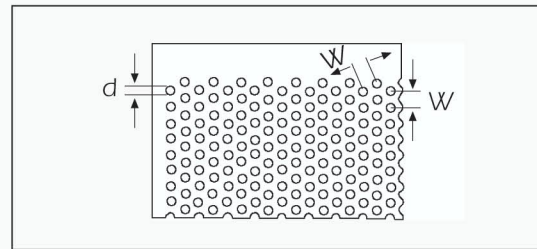
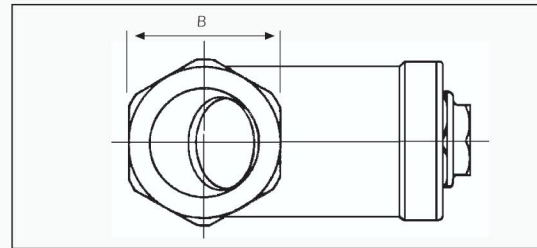
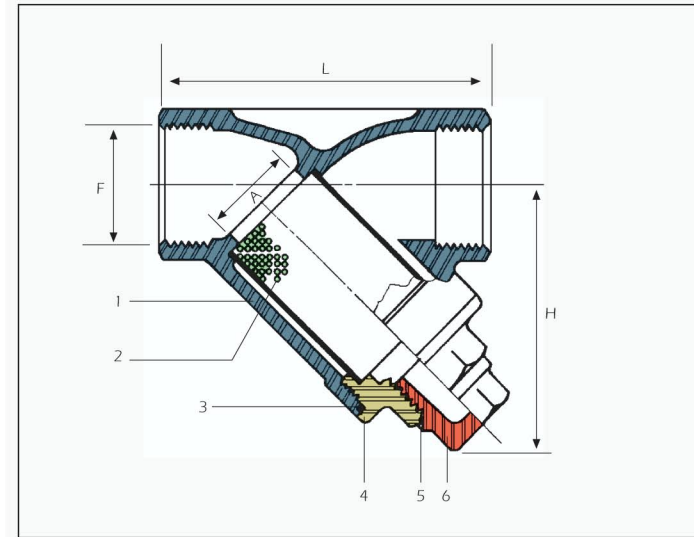

AYVAZ HACI AYVAZ ENDÜSTRİYEL MAMÜLLER
SANAYİ VE TİCARET A.Ş.

www.ayvaz.com
Atatürk Sanayi Bölgesi, İstasyon Mah. Mustafa İnan Cad. No: 36
34860 Hadimköy - İSTANBUL - TÜRKİYE
Tel : 90 (212) 771 01 45 (pbx)
Fax : 90 (212) 771 37 34 - 90 (212) 771 25 60, e-mail: info@ayvaz.com

DISTRIBUTOR